

Map pulled from *U.S. Marine in Lebanon 1982-1984*

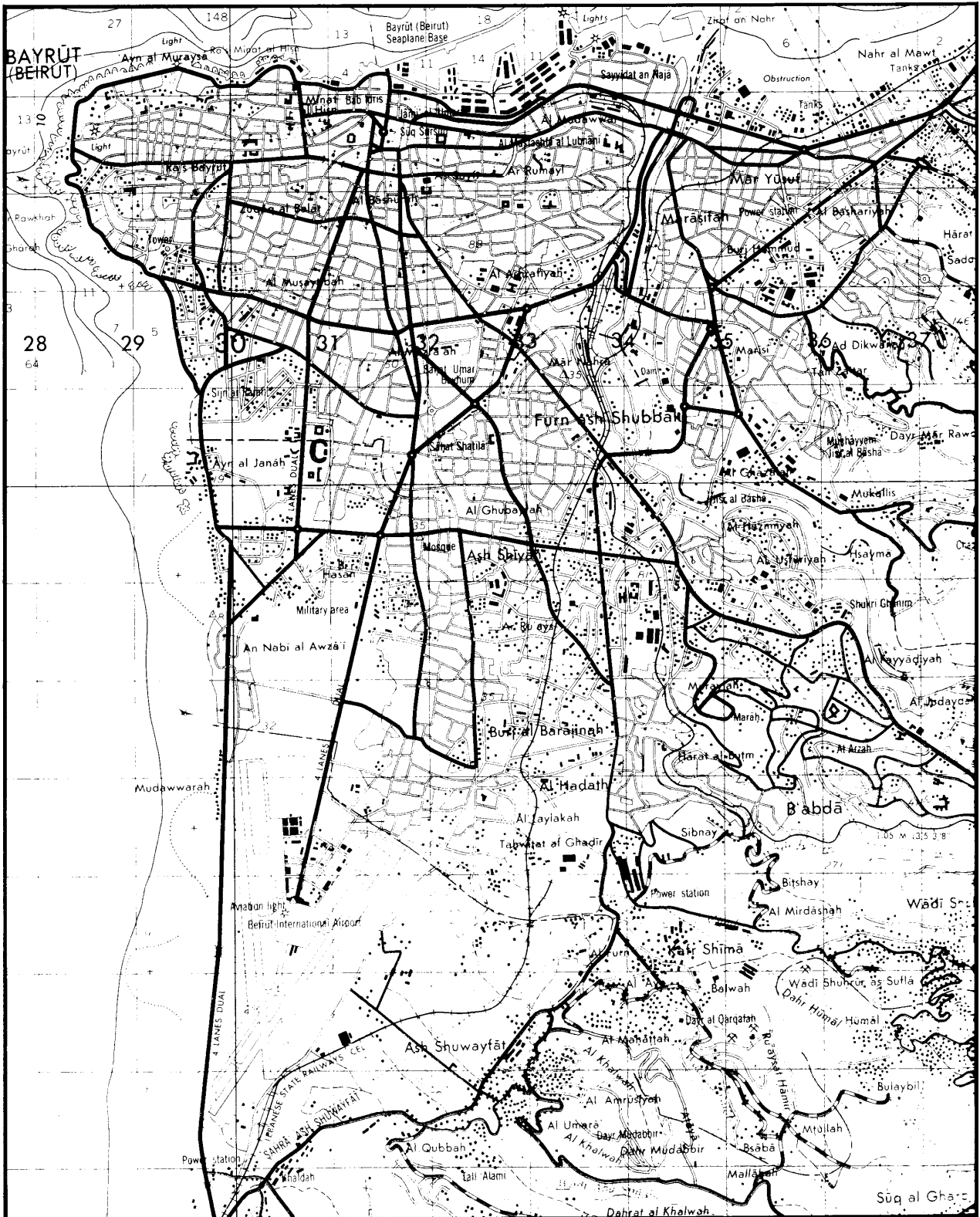

Defense Mapping Service

Beirut and its environs.

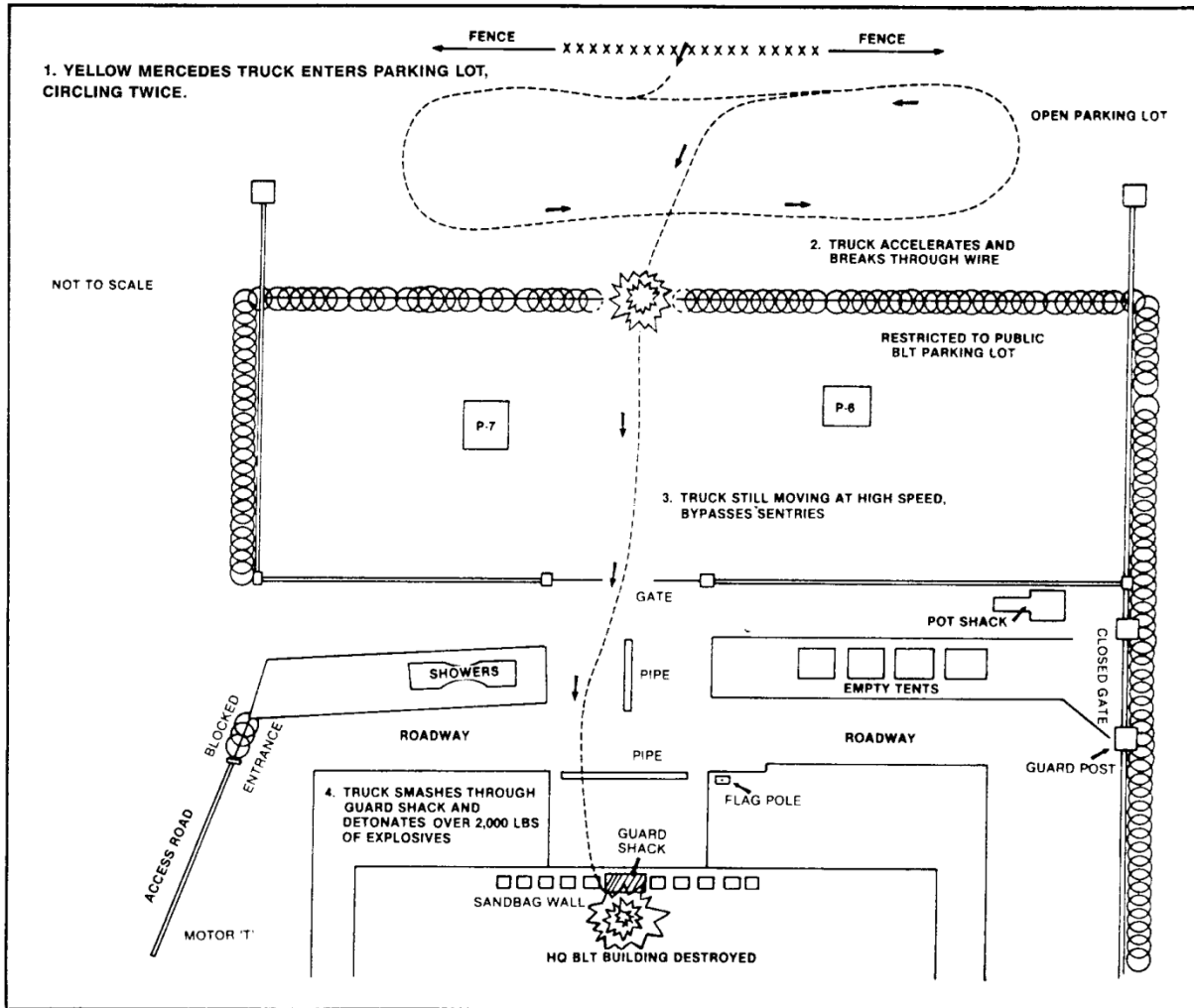
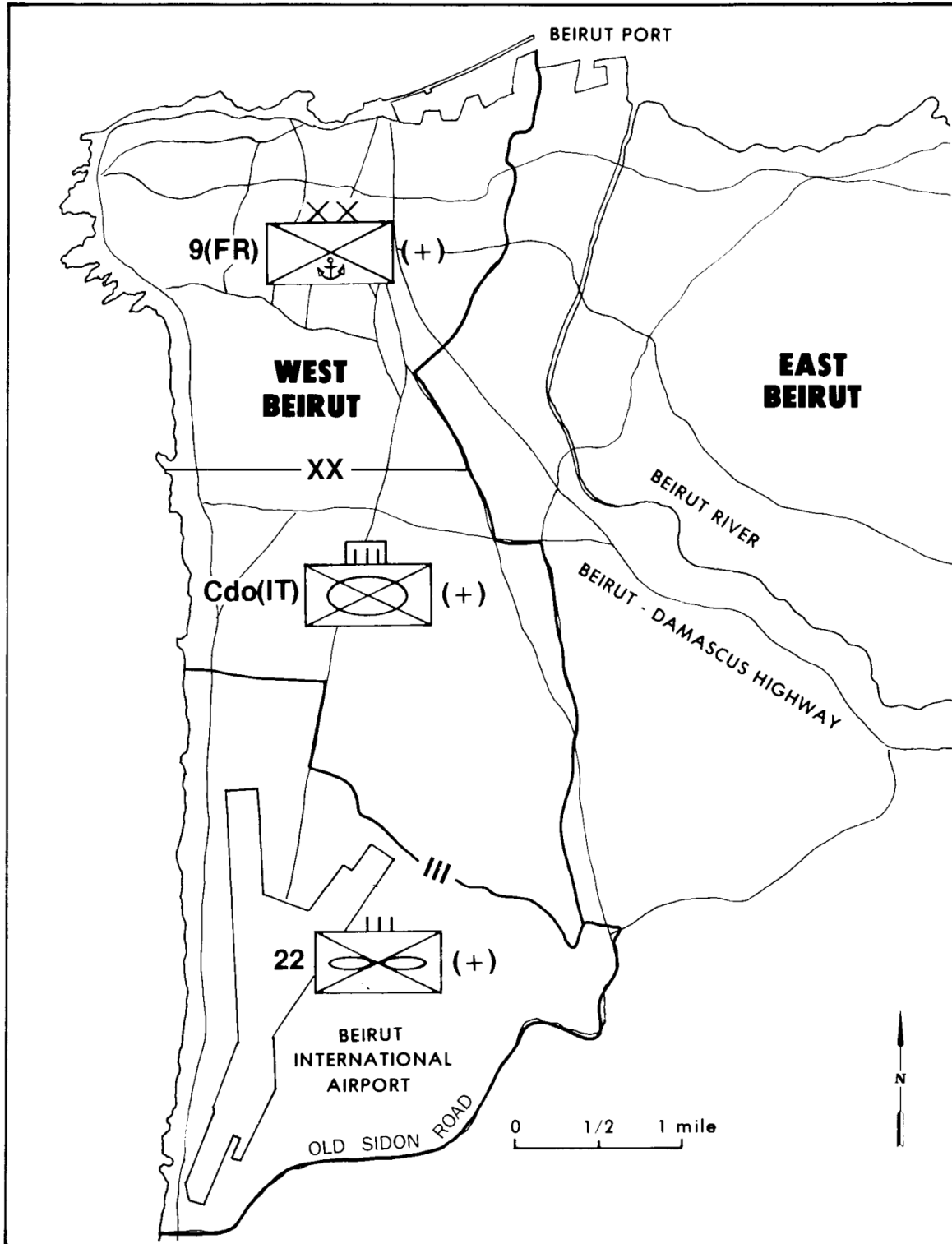

Figure 1

From Long Commission Report

Sketch map of the route taken by the terrorist bomber on the morning of 23 October 1983.

Map pulled from *U.S. Marine in Lebanon 1982-1984*



Sketch map courtesy *Marine Corps Gazette*
The zones of the Multi-National Force in September 1982.

Map pulled from *U.S. Marine in Lebanon 1982-1984*

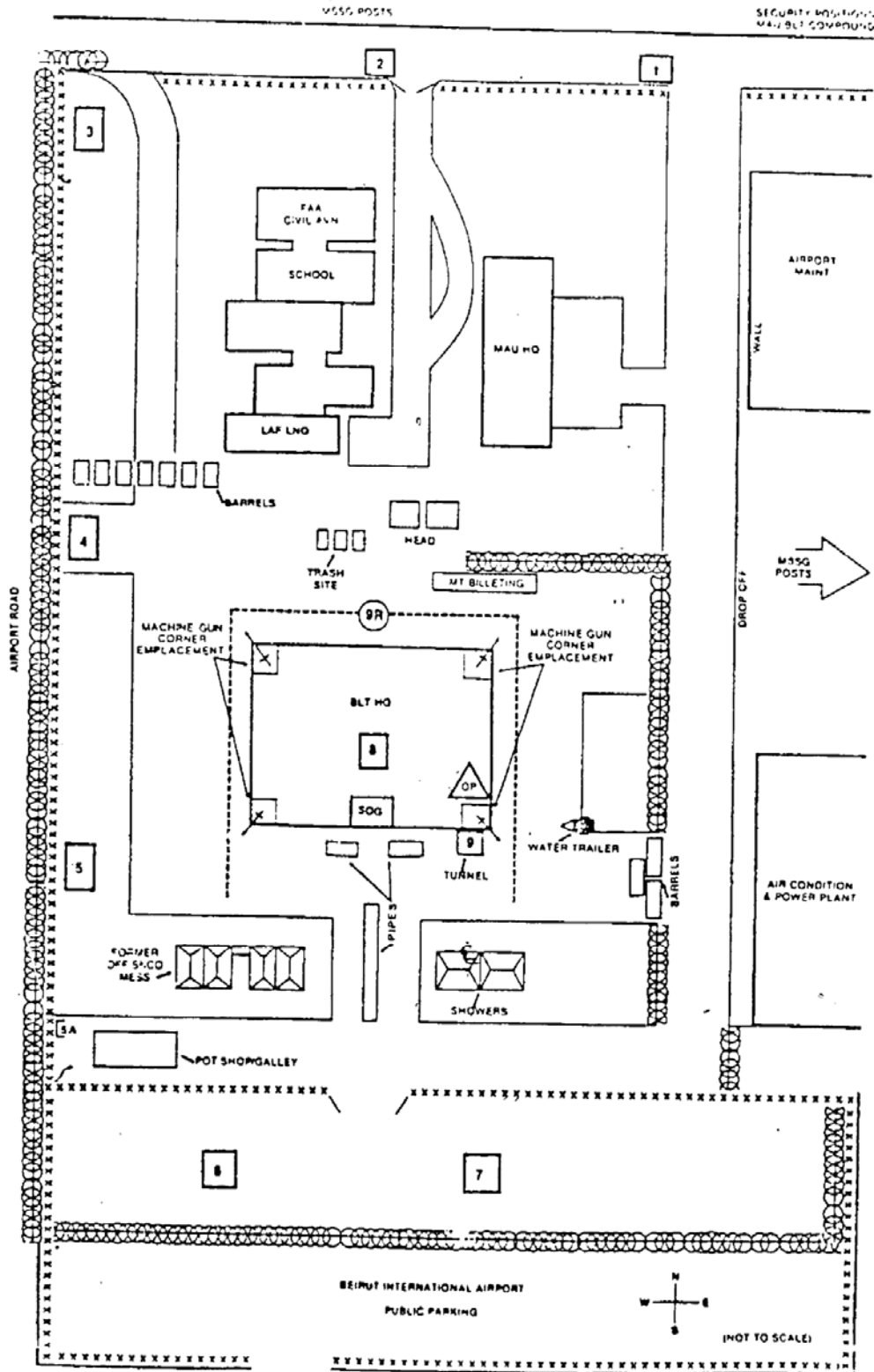
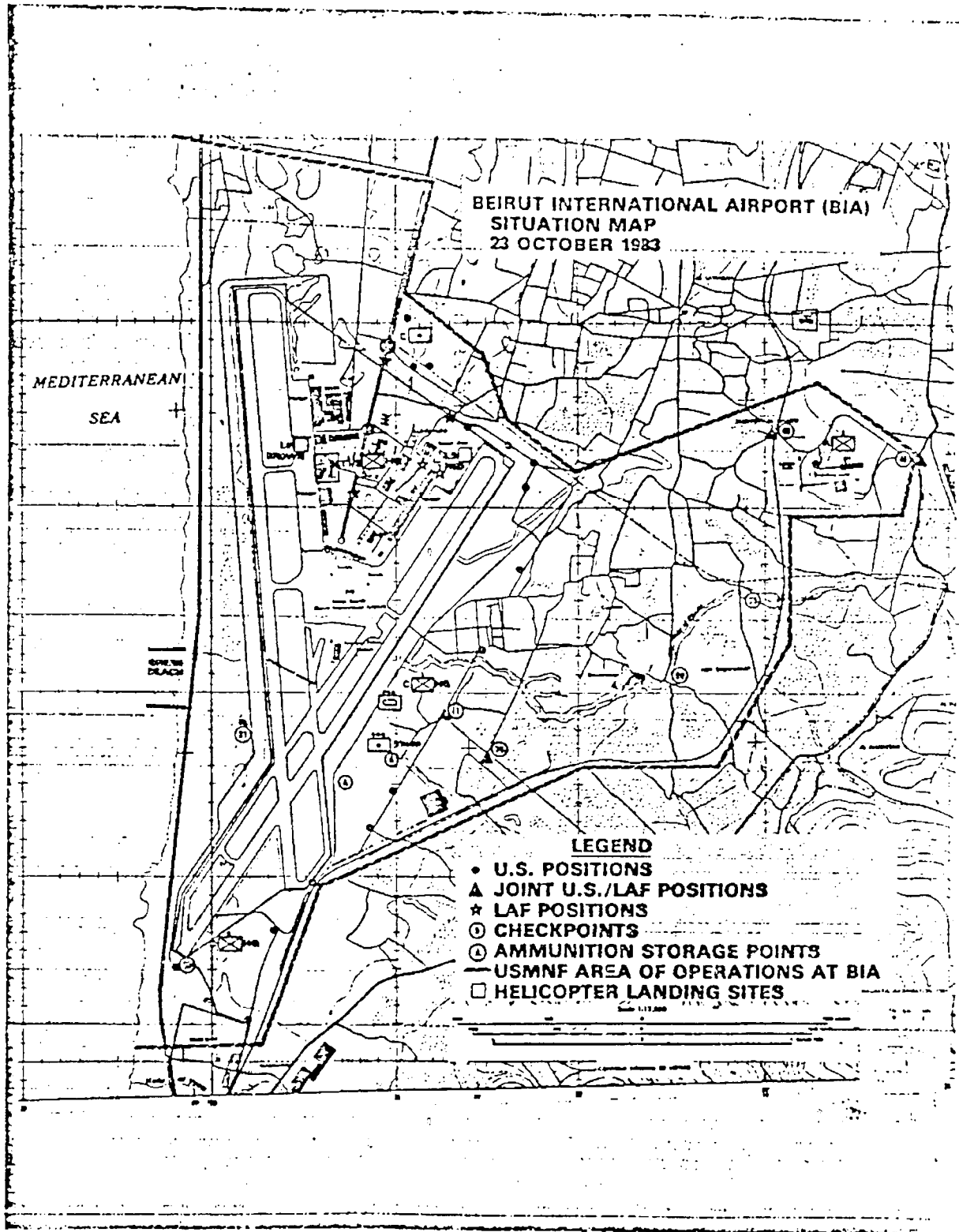

Figure 5-11 84

Map pulled from DOD Commission Report



Map pulled from DOD Commission Report